

RIGHT - OF - WAY		CROSSING		GA-TE-090.000	GA-TE-091.000	GA-TE-094.000	GA-TE-097.000	GA-TE-096.005.CR	GA-TE-100.000	GA-TE-102.000	
TRACT NUMBERS				7392+00	7396+00	7403+25	7403+51	7405+77	7406+99	7427+48	7445+00
RODDAGE				28.1	40.1	1.6	13.7	5.0	126.6	106.2	

SURVEY DATA
 SURVEY COMPANY:
 FIELD BOOK:
 PAGES:

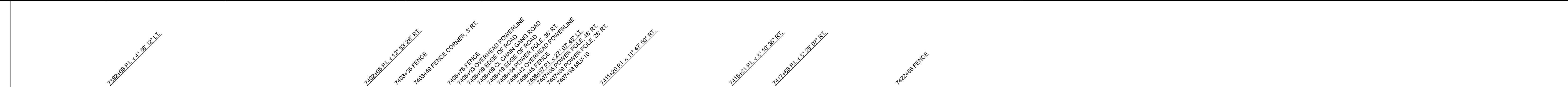

CLASS LOCATION
MINIMUM DEPTH OF COVER
PIPE MATERIAL
 - 3R, FITTING
 SET ON WEIGHT, GPW, GEOTEXTILE PIPE WEIGHT

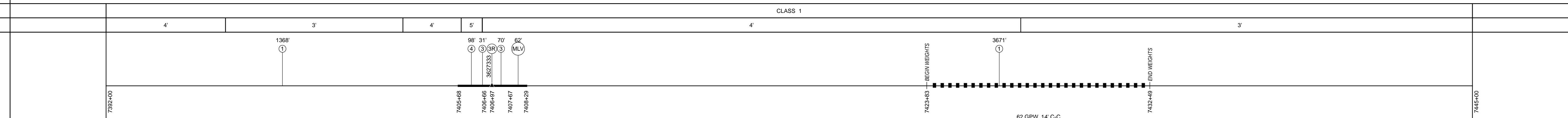

ALIGNMENT DETAIL

PROPOSED PIPELINE
 PROPOSED PERMANENT EASEMENT
 TEMP WORKSPACE
 ADD. TEMP. WORKSPACE
 EASEMENT LINE
 CL STREAM/CREEK/DITCH
 EDGE OF WATER
 CL LEVEE
 FIELD DELINEATED WETLAND
 STREAM/DRAIN/WATERBODY BNDRY
 CL ROAD
 EDGE OF ROAD PAVEMENT/CURB
 CL CULVERT
 CL RAILROAD
 ACCESS ROAD (PAR/TAR)
 STRUCTURE
 CONTOUR MAJOR (EVERY 10')
 CONTOUR MINOR (EVERY 2')
 PIPELINE MILEPOST
 PIPELINE MILEPOST 10TH
 PROPERTY LINE
 UNDERGROUND WATERLINE
 UNDERGROUND COM. CABLE
 UNDERGROUND POWERLINE
 UNDERGROUND SANITARY SEWER
 OVERHEAD POWERLINE
 OVERHEAD TELEPHONE
 VERIFIED PIPELINE
 FENCE
 TOP / TOE

TRANS. TOWER
 GUY ANCHOR
 HDD ENTRY/EXIT
 FIRE HYDRANT
 UTILITY POLE
 AERIAL MARKER
 ELEC. WATER, SAN. SEWER, GAS
 TELE. & STORM DRAIN MANHOLES

WELL
 SEPTIC
 VALVE
 METER
 SPREAD BREAK

DATE OF AERIAL PHOTOGRAPHY: MAY 27, 2013



REFERENCE DRAWING
 ENVIRONMENTAL SURVEY DATA

7392+00	7397+00	7402+00	7407+00	7412+00	7417+00	7422+00	7427+00	7432+00	7437+00	7442+00	7445+00
			6a, 6b, 18					W2TRC327 PFO			
								18			6a, 6b, 18

SENSITIVE AREAS

7392+00	7397+00	7402+00	7407+00	7412+00	7417+00	7422+00	7427+00	7432+00	7437+00	7442+00	7445+00
			6a, 6b, 18					W2TRC327 PFO			
								18			6a, 6b, 18

PROFILE
 SCALE:
 HORIZONTAL: 1" = 200'
 VERTICAL: 1" = 200'

THE LOCATION OF TRENCH PLUGS AND SLOPE BREAKERS ARE INTENDED TO BE USED AS A GUIDELINE ONLY. EXACT LOCATION TO BE DETERMINED IN THE FIELD AS DIRECTED BY THE CHIEF INSPECTOR.

SLOPE BREAKERS/ARROW INDICATES DIRECTION

TRENCH PLUG
 CP TEST STATION
 RECTIFIER
 DECOUPLER

SLOPE BREAKER & TRENCH PLUG SPACING

CODE	% SLOPE	SPACING
A	< 5%	NO STRUCTURE
B	5 - 15%	300 FT
C	15 - 30%	200 FT
D	> 30%	100 FT

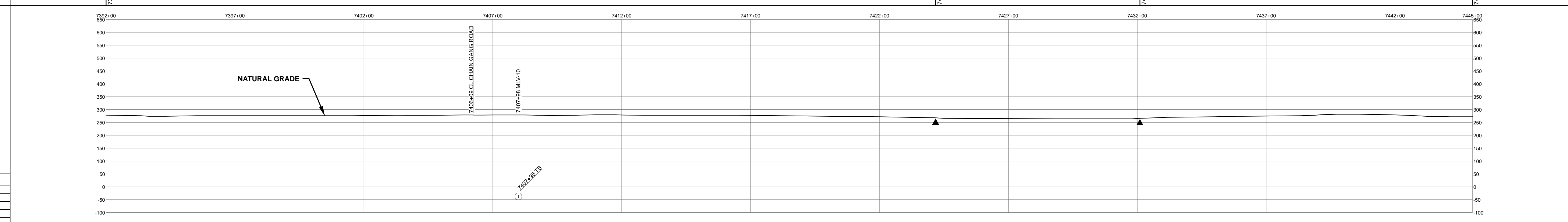

HYDROSTATIC TEST SECTION

REFERENCE DRAWINGS		REVISIONS			MATERIALS			ENGINEERING APPROVALS					
DWG. NO.	DESCRIPTION	REV	DRN	DATE	DESCRIPTION	ITEM NO.	DESCRIPTION	QTY	TITLE	SIGNATURE	DATE	SIGNATURE	DATE
1-G-1000-M LV10	PLOT PLAN - 36" MAINLINE VALVE NO. 10	0		06/29/2015	ISSUED FOR BID	1	36" O.D. x 0.520" W.T., API 5L X70, FBE 16 MILS w/I.D. EPOXY 1.7 MILS	5039 LF					
		1		03/14/2016	ISSUED FOR CONSTRUCTION	3	36" O.D. x 0.750" W.T., API 5L X70, FBE 16 MILS w/I.D. EPOXY 1.7 MILS	101 LF					
						4	36" O.D. x 0.750" W.T., API 5L X70, FBE 16 MILS, ARO 24 MILS, w/I.D. EPOXY 1.7 MILS	98 LF					
							MLV MAINLINE VALVE ASSEMBLY	62 LF					
							3R 3R ELBOW, HIGH STRENGTH WROUGHT BUTT-WELD FITTING, 36" O.D.	1 EA					
							GPW GEOTEXTILE PIPE WEIGHT, 9000 LBS	62 EA					

ENGINEERING APPROVALS

ENGINEERING APPROVALS	
BID	CONSTRUCTION
SIGNATURE	DATE
FRS	06/29/2015
FRS	03/14/2016

DRN DATE: 01/04/2016
 CHECKED BY: GIE
 CHK. DATE:

SABAL TRAIL PROJECT
PROPOSED 36" PIPELINE
STA. 7392+00 TO STA. 7445+00
ALIGNMENT SHEET

LOC. TERRELL COUNTY, GEORGIA

YEAR: 2017 **SHEET:** 141 OF 492 **SCALE:** 1" = 200' **DWG.** 1657-PL-DG-70197-141 **REV.** 1

Document Path: H:\GIS\1657\Deliverables\Alignment\Sheet\1657-PL-DG-70197-141.mxd