

RIGHT - OF - WAY										
TRACT NUMBERS	GA-BR-076.000									
RODDAGE	GA-BR-090.000.WC, GA-LO-001.005, GA-LO-000.250.RC, GA-LO-000.500.RR, GA-LO-001.000									
SURVEY DATA	12188+00, 12188+17 EDGE OF ROAD, 12201+72 EDGE OF ROAD, 12201+90 CL. SOUTH WIND FIELD ROAD, 12202+40 EDGE OF ROAD, 12206+73 CL. STREAM (UNKNOWN), 12220+64 CL. FIELD ROAD, EQUIPMENT CROSSING, 12222+21 HDD EXIT, 12224+90 CL. FIELD ROAD, 12227+86, 12230+78, 12233+64, 12238+31, 12240+83, 12241+00									
CLASS LOCATION	CLASS 1									
MINIMUM DEPTH OF COVER	5', 3', 5', 3', 5', 3', VARIES - 4'									
PIPE MATERIAL	56 GPW, 14" C-C, 27 GPW, 14" C-C, 1879'									

ALIGNMENT DETAIL

PROPOSED PIPELINE
 PROPOSED PERMANENT EASEMENT
 TEMP WORKSPACE
 ADD. TEMP. WORKSPACE
 EASEMENT LINE
 CL. STREAM/CREEK/DITCH
 EDGE OF WATER
 CL. LEVEE
 FIELD DELINEATED WETLAND
 STREAM/DRAIN/WATERBODY BNDRY
 CL. ROAD
 EDGE OF ROAD/PAVEMENT/CURB
 CL. CULVERT
 CL. RAILROAD
 ACCESS ROAD (PAR/TAR)
 STRUCTURE
 CONTOUR MAJOR (EVERY 10')
 CONTOUR MINOR (EVERY 2')
 PIPELINE MILEPOST
 PIPELINE MILEPOST 10TH
 PROPERTY LINE
 UNDERGROUND WATERLINE
 UNDERGROUND COM. CABLE
 UNDERGROUND POWERLINE
 UNDERGROUND SANITARY SEWER
 OVERHEAD POWERLINE
 OVERHEAD TELEPHONE
 VERIFIED PIPELINE
 FENCE
 TOP / TOE

DATE OF AERIAL PHOTOGRAPHY: MARCH 18, 2015

TRANS. TOWER
 GUY ANCHOR
 HDD ENTRY/EXIT
 FIRE HYDRANT
 UTILITY POLE
 AERIAL MARKER
 ELEC. WATER, SAN. SEWER, GAS
 TELE. & STORM DRAIN MANHOLES

WELL
 SEPTIC
 VALVE
 METER
 SPREAD BREAK



REFERENCE DRAWING	US-84 & WITHLACOOCHEE RIVER HDD - 1657-PL-DG-45108									
-------------------	--	--	--	--	--	--	--	--	--	--

ENVIRONMENTAL SURVEY DATA	12188+00	12188+09	W3TRC284 PFO	12195+17	12204+29	W3TRC282 PFO	W3TRC283 PFO	W3TRC282 PFO	12227+49	W3TRC303 PFO	S3TRC304	12229+06	W3TRC303 PFO	12235+61	WB3TRC302	W3TRC301 PFO	12241+00
SENSITIVE AREAS	6a, 6b, 8, 18	8, 18	8, 18	6a, 6b, 8, 18	8, 18	6a, 6b, 8, 18	6a, 6b, 8, 18	6a, 6b, 8, 18	8, 16, 18	8, 16, 18	8, 16, 18	8, 16, 18	8, 16, 18	6a, 6b, 8, 16, 18	8, 16, 18	6a, 6b, 8, 16, 18	12241+00

PROFILE

SCALE:
 HORIZONTAL: 1" = 200'
 VERTICAL: 1" = 200'

THE LOCATION OF TRENCH PLUGS AND SLOPE BREAKERS ARE INTENDED TO BE USED AS A GUIDELINE ONLY. EXACT LOCATION TO BE DETERMINED IN THE FIELD AS DIRECTED BY THE CHIEF INSPECTOR.

SLOPE BREAKERS/ARROW INDICATES DIRECTION

TRENCH PLUG
 CP TEST STATION
 RECTIFIER
 DECOUPLER

SLOPE BREAKER & TRENCH PLUG SPACING		
CODE	% SLOPE	SPACING
A	< 5%	NO STRUCTURE
B	5 - 15%	300 FT
C	15 - 30%	200 FT
D	> 30%	100 FT

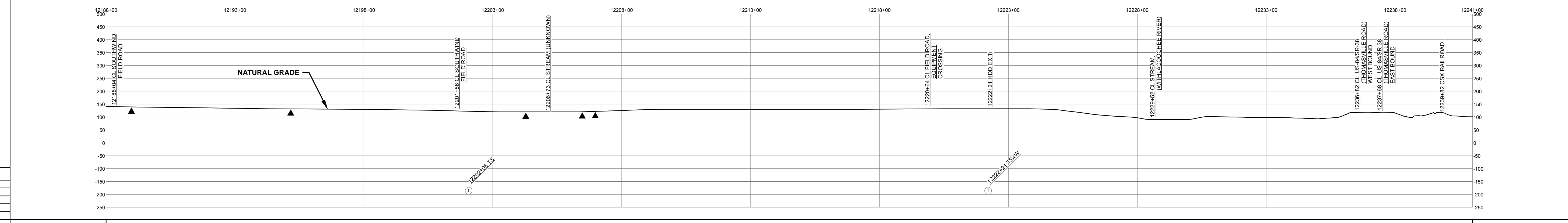

HYDROSTATIC TEST SECTION				TEST SECTION 20				ENGINEERING APPROVALS				SABAL TRAIL PROJECT PROPOSED 36" PIPELINE STA. 12188+00 TO STA. 12241+00 ALIGNMENT SHEET				Sabal Trail TRANSMISSION	
REFERENCE DRAWINGS		REVISIONS		MATERIALS		TITLE		SIGNATURE		DATE		SIGNATURE		DATE		LOC. BROOKS & LOWNDES COUNTIES, GEORGIA	
DWG. NO.	DESCRIPTION	REV	DRN	DATE	DESCRIPTION	ITEM NO.	DESCRIPTION	QTY									
		0		06/29/2015	ISSUED FOR BID	1	36" O.D. x 0.520" W.T., API 5L X70, FBE 16 MILS w/ I.D. EPOXY 1.7 MILS	3421 LF									
		1		03/14/2016	ISSUED FOR CONSTRUCTION	4	36" O.D. x 0.750" W.T., API 5L X70, FBE 16 MILS, ARO 24 MILS, w/ I.D. EPOXY 1.7 MILS	1879 LF									
							GPW	GEOTEXTILE PIPE WEIGHT, 8000 LBS	83 EA								
								YEAR: 2017				SHEET: 233 OF 492		SCALE: 1" = 200'		DWG. 1657-PL-DG-70197-233	
								CHK. DATE:								REV. 1	

Document Path: H:\GIS\1657\Deliverables\Alignment\Sheets\1657-PL-DG-70197-233.mxd