

RIGHT - OF - WAY TRACT NUMBERS	HCL-FL-OS-025.000		HCL-FL-OS-020.030		HCL-FL-OS-020.050		HCL-FL-OS-025.006	
	263+00		273+00		283+00		304+00	
RODDAGE	64.2		131.5		52.8			

SURVEY DATA
 SURVEY COMPANY:
 FIELD BOOK:
 PAGES:

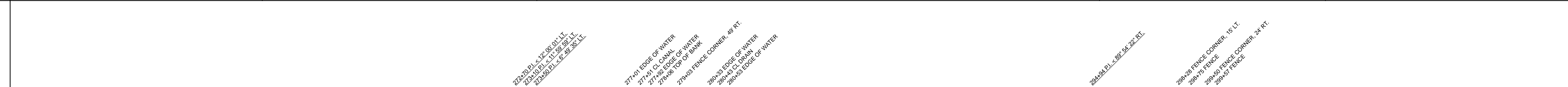

CLASS LOCATION
MINIMUM DEPTH OF COVER

CLASS 1	
3'	5'
3'	5'
3'	3'

PIPE MATERIAL
 - 3R, FITTING
 SET ON WEIGHT, GPW, GEOTEXTILE PIPE WEIGHT

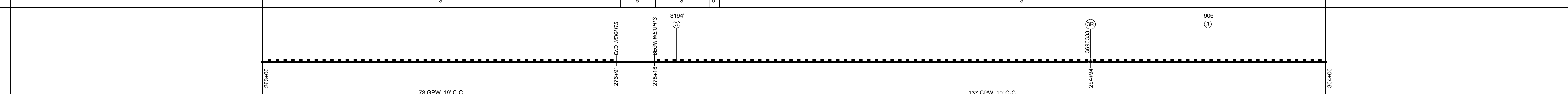

ALIGNMENT DETAIL

- PROPOSED PIPELINE
- PROPOSED PERMANENT EASEMENT
- TEMP WORKSPACE
- ADD. TEMP. WORKSPACE
- EASEMENT LINE
- CL STREAM/CREEK/DITCH
- EDGE OF WATER
- CL LEVEE
- FIELD DELINEATED WETLAND
- STREAM/DRAIN/WATERBODY BNDRY
- CL ROAD
- EDGE OF ROAD/PAVEMENT/CURB
- CL CULVERT
- CL RAILROAD
- ACCESS ROAD (PAR/TAR)
- STRUCTURE
- CONTOUR MAJOR (EVERY 10')
- CONTOUR MINOR (EVERY 2')
- PIPELINE MILEPOST
- PIPELINE MILEPOST 10TH
- PROPERTY LINE
- UNDERGROUND WATERLINE
- UNDERGROUND COM. CABLE
- UNDERGROUND POWERLINE
- UNDERGROUND SANITARY SEWER
- OVERHEAD POWERLINE
- OVERHEAD TELEPHONE
- VERIFIED PIPELINE
- FENCE
- TOP / TOE

DATE OF AERIAL PHOTOGRAPHY: APRIL 14, 2015



REFERENCE DRAWING

ENVIRONMENTAL SURVEY DATA	W13CAR028 PFO	W6CAR155 PEM	W6CAR222 PFO	W9ECT228 PFO	W6CAR223 PFO	W6CAR221 PEM	W6CAR223 PFO	W9ECT228 PFO
SENSITIVE AREAS	8, 16, 18	6a, 6b, 8, 16, 18	8, 16, 18					

PROFILE
 SCALE:
 HORIZONTAL: 1" = 200'
 VERTICAL: 1" = 200'

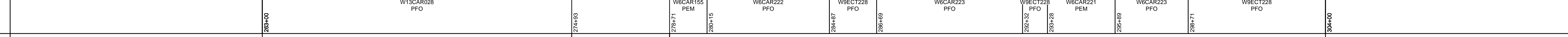

HYDROSTATIC TEST SECTION

REV	DRN	DATE	DESCRIPTION	ITEM NO.	DESCRIPTION	QTY
0		06/29/2015	ISSUED FOR BID	3	36" O.D. x 0.750" W.T., API 5L X70, FBE 16 MILS w/I.D. EPOXY 1.7 MILS	4100 LF
1		03/14/2016	ISSUED FOR CONSTRUCTION	3R	3R ELBOW, HIGH STRENGTH WROUGHT BUTT-WELD FITTING, 36" O.D.	1 EA
				GPW	GEOTEXTILE PIPE WEIGHT, 9000 LBS	210 EA

REVISIONS

DWG. NO.	DESCRIPTION	REV	DRN	DATE	DESCRIPTION	ITEM NO.	DESCRIPTION	QTY
		0		06/29/2015	ISSUED FOR BID	3	36" O.D. x 0.750" W.T., API 5L X70, FBE 16 MILS w/I.D. EPOXY 1.7 MILS	4100 LF
		1		03/14/2016	ISSUED FOR CONSTRUCTION	3R	3R ELBOW, HIGH STRENGTH WROUGHT BUTT-WELD FITTING, 36" O.D.	1 EA
						GPW	GEOTEXTILE PIPE WEIGHT, 9000 LBS	210 EA

ENGINEERING APPROVALS

TITLE		SIGNATURE		DATE	
DRAWN BY:	GIE	FSR	06/29/2015	FSR	03/14/2016
DRN. DATE:	01/04/2016	DRS	06/29/2015	JC	03/14/2016
CHECKED BY:	GIE	DRS	06/29/2015	JC	03/14/2016
CHK. DATE:					

TEST SECTION H1



SABAL TRAIL PROJECT
 PROPOSED 36" HUNTERS CREEK PIPELINE
 STA. 263+00 TO STA. 304+00
 ALIGNMENT SHEET

LOC. OSCEOLA COUNTY, FLORIDA
 YEAR: 2017 SHEET: 6 OF 14 SCALE: 1" = 200' DWG. 1657-HCL-DG-70197-006 REV. 1

DATE OF AERIAL PHOTOGRAPHY: APRIL 14, 2015

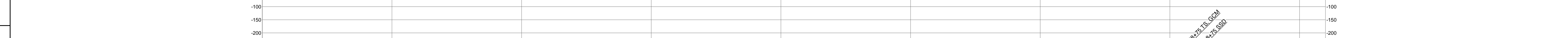

SCALE:
 HORIZONTAL: 1" = 200'
 VERTICAL: 1" = 200'

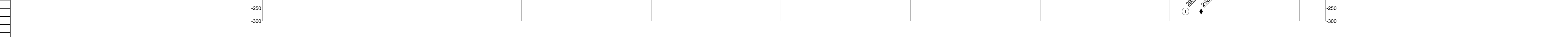

HYDROSTATIC TEST SECTION

REV	DRN	DATE	DESCRIPTION	ITEM NO.	DESCRIPTION	QTY
0		06/29/2015	ISSUED FOR BID	3	36" O.D. x 0.750" W.T., API 5L X70, FBE 16 MILS w/I.D. EPOXY 1.7 MILS	4100 LF
1		03/14/2016	ISSUED FOR CONSTRUCTION	3R	3R ELBOW, HIGH STRENGTH WROUGHT BUTT-WELD FITTING, 36" O.D.	1 EA
				GPW	GEOTEXTILE PIPE WEIGHT, 9000 LBS	210 EA

ENGINEERING APPROVALS

TITLE		SIGNATURE		DATE	
DRAWN BY:	GIE	FSR	06/29/2015	FSR	03/14/2016
DRN. DATE:	01/04/2016	DRS	06/29/2015	JC	03/14/2016
CHECKED BY:	GIE	DRS	06/29/2015	JC	03/14/2016
CHK. DATE:					

SABAL TRAIL PROJECT
 PROPOSED 36" HUNTERS CREEK PIPELINE
 STA. 263+00 TO STA. 304+00
 ALIGNMENT SHEET

LOC. OSCEOLA COUNTY, FLORIDA
 YEAR: 2017 SHEET: 6 OF 14 SCALE: 1" = 200' DWG. 1657-HCL-DG-70197-006 REV. 1

DATE OF AERIAL PHOTOGRAPHY: APRIL 14, 2015

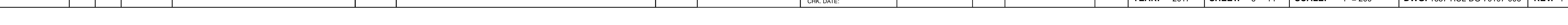

SCALE:
 HORIZONTAL: 1" = 200'
 VERTICAL: 1" = 200'

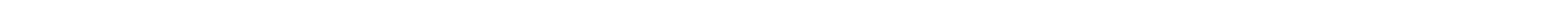

HYDROSTATIC TEST SECTION

REV	DRN	DATE	DESCRIPTION	ITEM NO.	DESCRIPTION	QTY
0		06/29/2015	ISSUED FOR BID	3	36" O.D. x 0.750" W.T., API 5L X70, FBE 16 MILS w/I.D. EPOXY 1.7 MILS	4100 LF
1		03/14/2016	ISSUED FOR CONSTRUCTION	3R	3R ELBOW, HIGH STRENGTH WROUGHT BUTT-WELD FITTING, 36" O.D.	1 EA
				GPW	GEOTEXTILE PIPE WEIGHT, 9000 LBS	210 EA

ENGINEERING APPROVALS

TITLE		SIGNATURE		DATE	
DRAWN BY:	GIE	FSR	06/29/2015	FSR	03/14/2016
DRN. DATE:	01/04/2016	DRS	06/29/2015	JC	03/14/2016
CHECKED BY:	GIE	DRS	06/29/2015	JC	03/14/2016
CHK. DATE:					

SABAL TRAIL PROJECT
 PROPOSED 36" HUNTERS CREEK PIPELINE
 STA. 263+00 TO STA. 304+00
 ALIGNMENT SHEET

LOC. OSCEOLA COUNTY, FLORIDA
 YEAR: 2017 SHEET: 6 OF 14 SCALE: 1" = 200' DWG. 1657-HCL-DG-70197-006 REV. 1

DATE OF AERIAL PHOTOGRAPHY: APRIL 14, 2015

SCALE:
 HORIZONTAL: 1" = 200'
 VERTICAL: 1" = 200'

HYDROSTATIC TEST SECTION

REV	DRN	DATE	DESCRIPTION	ITEM NO.	DESCRIPTION	QTY
0		06/29/2015	ISSUED FOR BID	3	36" O.D. x 0.750" W.T., API 5L X70, FBE 16 MILS w/I.D. EPOXY 1.7 MILS	4100 LF
1		03/14/2016	ISSUED FOR CONSTRUCTION	3R	3R ELBOW, HIGH STRENGTH WROUGHT BUTT-WELD FITTING, 36" O.D.	1 EA
				GPW	GEOTEXTILE PIPE WEIGHT, 9000 LBS	210 EA

ENGINEERING APPROVALS

TITLE		SIGNATURE		DATE	
DRAWN BY:	GIE	FSR	06/29/2015	FSR	03/14/2016
DRN. DATE:	01/04/2016	DRS	06/29/2015	JC	03/14/2016
CHECKED BY:	GIE	DRS	06/29/2015	JC	03/14/2016
CHK. DATE:					

SABAL TRAIL PROJECT
 PROPOSED 36" HUNTERS CREEK PIPELINE
 STA. 263+00 TO STA. 304+00
 ALIGNMENT SHEET

LOC. OSCEOLA COUNTY, FLORIDA
 YEAR: 2017 SHEET: 6 OF 14 SCALE: 1" = 200' DWG. 1657-HCL-DG-70197-006 REV. 1

DATE OF AERIAL PHOTOGRAPHY: APRIL 14, 2015

SCALE:
 HORIZONTAL: 1" = 200'
 VERTICAL: 1" = 200'

HYDROSTATIC TEST SECTION

REV	DRN	DATE	DESCRIPTION	ITEM NO.	DESCRIPTION	QTY
0		06/29/2015	ISSUED FOR BID	3	36" O.D. x 0.750" W.T., API 5L X70, FBE 16 MILS w/I.D. EPOXY 1.7 MILS	4100 LF
1		03/14/2016	ISSUED FOR CONSTRUCTION	3R	3R ELBOW, HIGH STRENGTH WROUGHT BUTT-WELD FITTING, 36" O.D.	1 EA
				GPW	GEOTEXTILE PIPE WEIGHT, 9000 LBS	210 EA

ENGINEERING APPROVALS

TITLE		SIGNATURE		DATE	
DRAWN BY:	GIE	FSR	06/29/2015	FSR	03/14/2016
DRN. DATE:	01/04/2016	DRS	06/29/2015	JC	03/14/2016
CHECKED BY:	GIE	DRS	06/29/2015	JC	03/14/2016
CHK. DATE:					

SABAL TRAIL PROJECT
 PROPOSED 36" HUNTERS CREEK PIPELINE
 STA. 263+00 TO STA. 304+00
 ALIGNMENT SHEET

LOC. OSCEOLA COUNTY, FLORIDA
 YEAR: 2017 SHEET: 6 OF 14 SCALE: 1" = 200' DWG. 1657-HCL-DG-70197-006 REV. 1

DATE OF AERIAL PHOTOGRAPHY: APRIL 14, 2015

SCALE:
 HORIZONTAL: 1" = 200'
 VERTICAL: 1" = 200'

HYDROSTATIC TEST SECTION

REV	DRN	DATE	DESCRIPTION	ITEM NO.	DESCRIPTION	QTY
0		06/29/2015	ISSUED FOR BID	3	36" O.D. x 0.750" W.T., API 5L X70, FBE 16 MILS w/I.D. EPOXY 1.7 MILS	4100 LF
1		03/14/2016	ISSUED FOR CONSTRUCTION	3R	3R ELBOW, HIGH STRENGTH WROUGHT BUTT-WELD FITTING, 36" O.D.	1 EA
				GPW	GEOTEXTILE PIPE WEIGHT, 9000 LBS	210 EA

ENGINEERING APPROVALS

TITLE		SIGNATURE		DATE	
DRAWN BY:	GIE	FSR	06/29/2015	FSR	03/14/2016
DRN. DATE:	01/04/2016	DRS	06/29/2015	JC	03/14/2016
CHECKED BY:	GIE	DRS	06/29/2015	JC	03/14/2016
CHK. DATE:					

SABAL TRAIL PROJECT
 PROPOSED 36" HUNTERS CREEK PIPELINE
 STA. 263+00 TO STA. 304+00
 ALIGNMENT SHEET

LOC. OSCEOLA COUNTY, FLORIDA
 YEAR: 2017 SHEET: 6 OF 14 SCALE: 1" = 200' DWG. 1657-HCL-DG-70197-006 REV. 1

DATE OF AERIAL PHOTOGRAPHY: APRIL 14, 2015

SCALE:
 HORIZONTAL: 1" = 200'
 VERTICAL: 1" = 200'

