

**MADISON HIGHWAY (S.R. 31)
EXISTING TYPICAL SECTION**

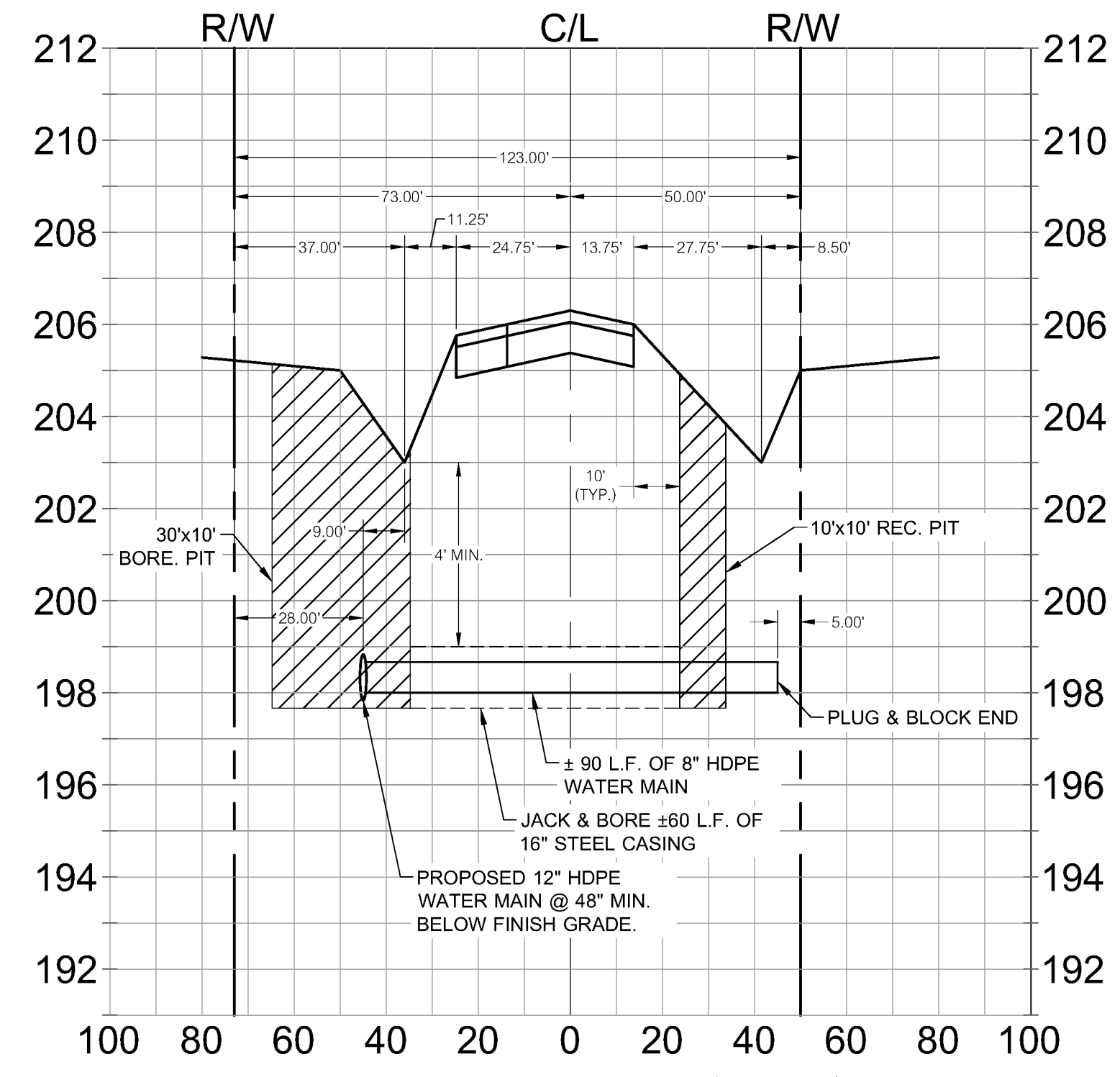

**MADISON HIGHWAY (S.R. 31)
JACK & BORE SECTION**

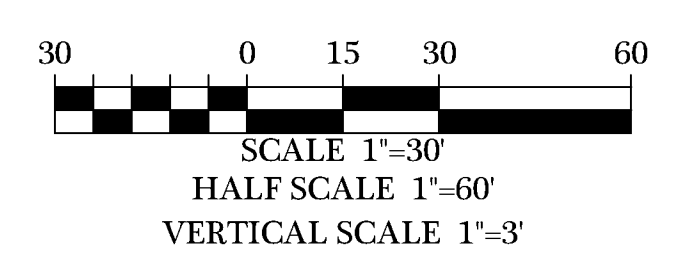
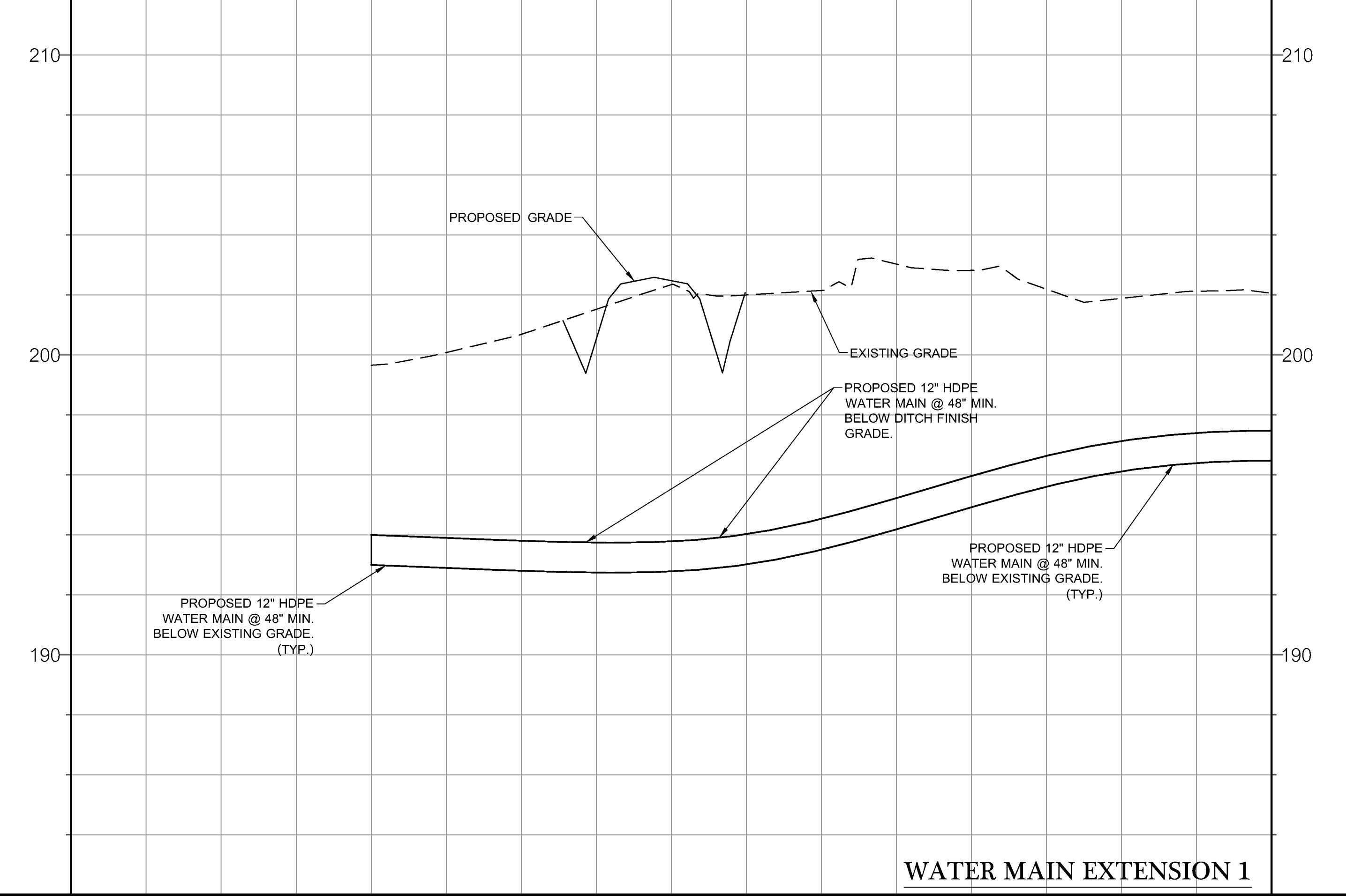
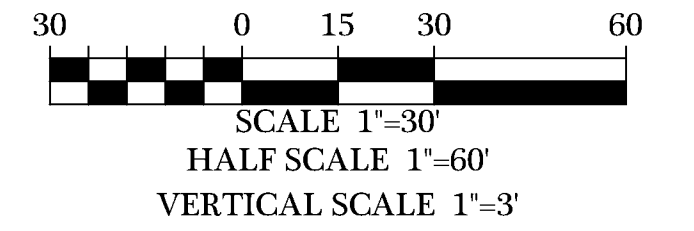
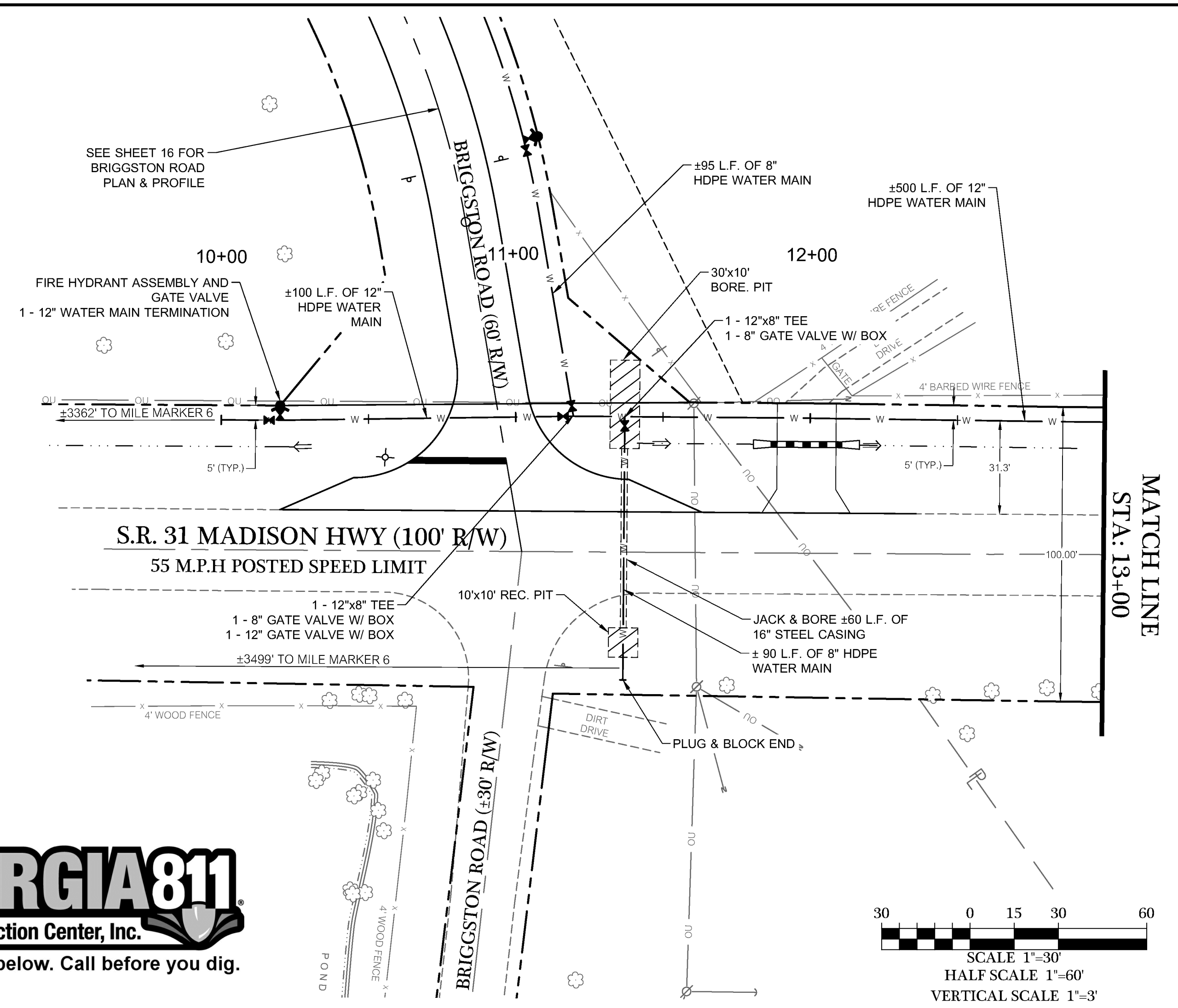
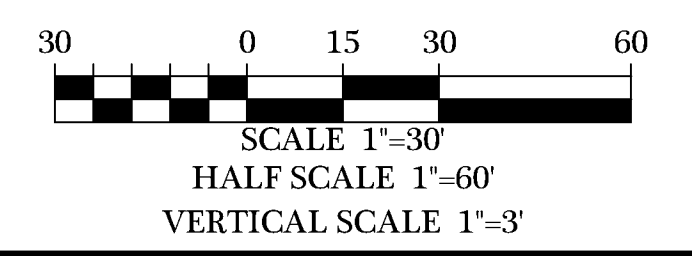

WATER MAIN EXTENSION 1

DATE	REVISIONS
06/24/2022	REVISIONS PER COUNTY COMMENTS
06/24/2022	REVISIONS PER COUNTY COMMENTS
07/14/2022	REVISIONS PER COUNTY COMMENTS
07/14/2022	REVISIONS PER COUNTY COMMENTS
07/14/2022	REVISIONS PER COUNTY COMMENTS

**BRIGGSTON ROAD
PAVING IMPROVEMENTS**
LOWNDES COUNTY, GEORGIA
L.L. 20, 21, 24, 25, & 26 OF THE 16TH L.D.
& L.L. 70 & 71 OF THE 11TH L.D.

INNOVATE!
Engineering & Surveying
PHONE: 229-249-9113 - www.innovatees.com
2214 N. Patterson Street, Valdosta, GA 31602



LEVEL II CERT. 8141
DATE: 09/14/2022
DRAWN BY: M. WILSON
CHECKED BY: B. KENT

10+00 11+00 12+00 13+00