

PLAT OF SURVEY FOR
 THE J. DUNCAN LEGGETTE ESTATE
 LOCATED IN
 LAND LOT 88
 12th LAND DISTRICT
 LOWMEDE COUNTY, GEORGIA
 09 APRIL 1998
 SCALE: 1" = 60'

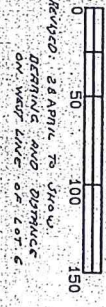

THE FIELD DATA FROM WHICH THIS PLAT IS BASED HAS A CLOSURE PRECISION WITH AN UNUSUAL ORDER OF M. PER ANGLE POINT AND WAS ADJUSTED BY THE METHOD OF LEAST SQUARES FOR ACCURATE WITHIN 1/1000 IN 1000. EQUIPMENT USED: SOKKIA SETZ SURVEYING INSTRUMENTS, MODEL S11110N AND 100' TAPE.

LEGEND:
 L.F.S. = L.F.S. FOUND
 R.F.P. = REBAR PLACED
 C.M. = CONCRETE MONUMENT FOUND
 B.M. = BENCHMARK FOUND
 X = POINT OF INTEREST
 --- = FENCE
 --- X --- = NOT TO SCALE
 NOTE: ALL PROPERTY CORNERS ARE MARKED WITH A NO. 5 REBAR



POISSON SURVEYING
 1206 HASTINGS DRIVE
 VALDOSTA, GA. 31601
 912 - 244 - 2920